

Technical Data Sheet



Catalog No. N48LF2D-9

Characteristics	
Phase	3
KVA	9
Primary	480Δ
Secondary	240Δ
Conductor	Aluminum
Temp. Rise	115° C
Frequency	60 HZ
Taps	-2@5%
ESS	No
Insulation	180° C
Weathershield	N/A
Wall Bracket	Built-In
Weight (lbs)	270
Sound(dB)	40

Notes

All units are UL listed and are designed in accordance with applicable NEMA, ANSI and IEEE standards.

Transformers are dry-type AA, non-ventilated NEMA 3R enclosure

Transformers are wall mounted. Wall mounting bracket is built into the enclosure.

Paint color is ANSI 61.

AMP Ratings

Line In (Primary) @ 480V 10.8A

Load (Secondary) @ 240V 21.7 A

Winding Diagram - 14

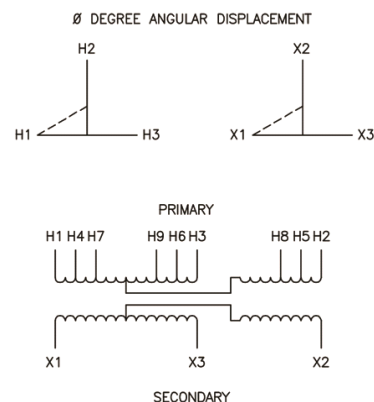

VOLTS	CONNECTIONS	LINE LEADS
480		H1, H2, H3
456		H4, H5, H6
432		H7, H8, H9
240		X1, X2, X3

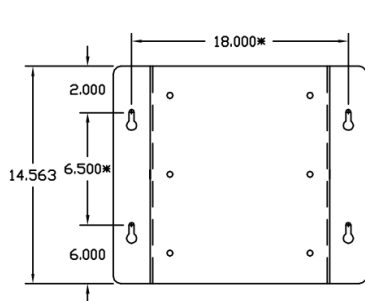

BACK VIEW

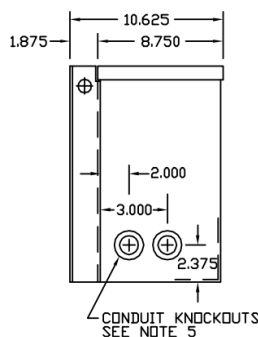

SIDE VIEW

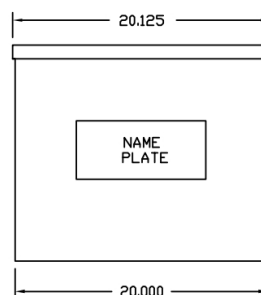

FRONT VIEW

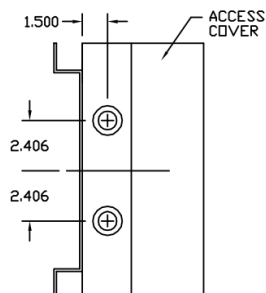

Outline No: 08A7634